

OPEN BELT DRIVES

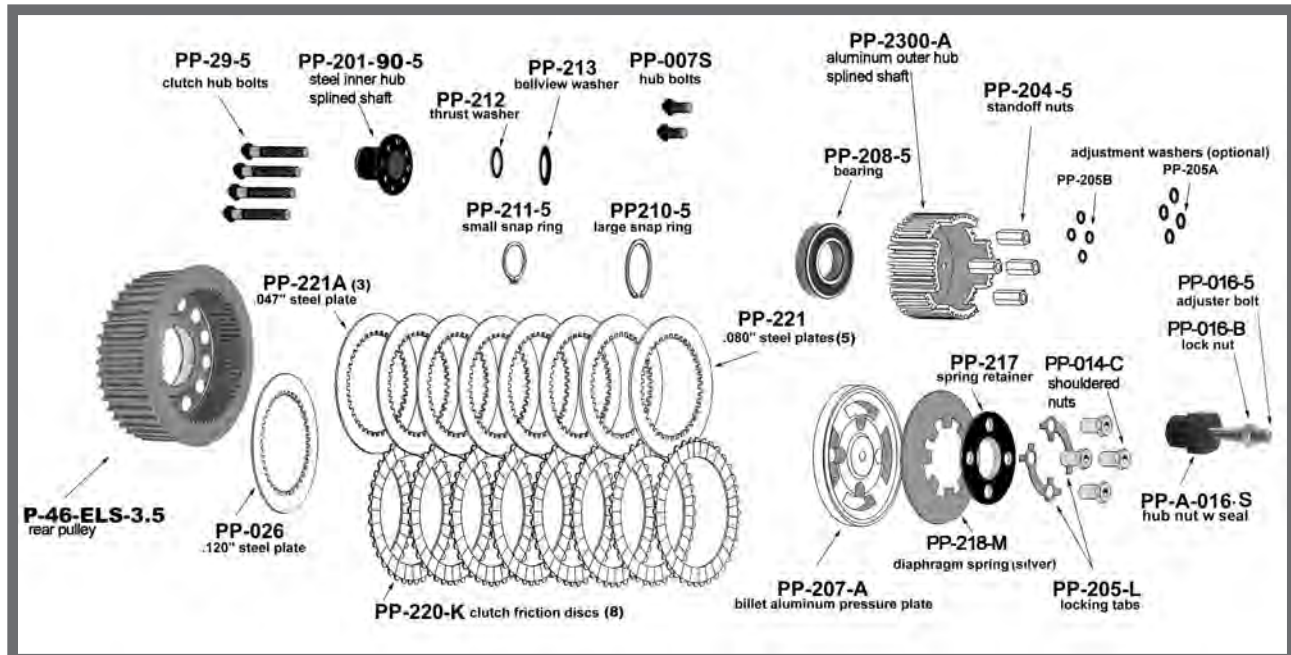

CLUTCH ASSEMBLY- BRUTE V™ DIRECT DRIVE™ / 3-1/2" WIDE / 14mm BELT



- PP-007-90-5 . . . CLUTCH HUB / NEW STYLE ASSY w/STEEL INNER & ALUMINUM OUTER / FITS EVO SPLINED SHAFT ON 1990-2006 w/BRUTE V™ KITS**
- PP-201-90-5 . . . CLUTCH HUB / STEEL INNER / FOR EVO SPLINED SHAFT**
- PP-2300-A CLUTCH HUB / ALUMINUM OUTER**
- PP-007-S CLUTCH HUB BOLTS 1/4-28 x 3/8" (REQUIRES QTY 2)**
- PP-29-5 BOLTS FOR STEEL INNER HUB 5/16-18 x 2-1/2" BUTTON HEAD ALLEN (REQUIRES QTY 4)**
- PP-204-5 STAND-OFF NUTS FOR CLUTCH HUB (REQUIRES QTY 4)**
- PP-213 BELLVIEW WASHER / FITS 1990 & LATER MODELS**
- PP-212 THRUST WASHER (HARDENED) / FITS 1990 & LATER**
- PP-208-5 BEARING FOR CLUTCH BASKET**
- PP-210-5 LARGE SNAP RING / RETAINER FOR CLUTCH BASKET**
- PP-211-5 SMALL SNAP RING FOR REAR OF CLUTCH HUB**
- PP-016-S CLUTCH HUB NUT**
- PP-016-B JAMNUT / CLUTCH ADJUSTING SCREW**
- PP-205-AB SHIMS FOR CLUTCH PACK / 4 LARGE & 4 SMALL**
- PBC-4-K CLUTCH PACK, KEVLAR / REPLACEMENT CLUTCH PACK / PACK HEIGHT = 1.900" - 1.920"**
- PP-220-K KEVLAR FRICTION PLATES / .150" (REQUIRES QTY 8)**
- PP-026 STEEL DRIVE PLATE / .120" THICK FOR REAR OF NEW HUB / REPLACES ALUMINUM BACKING PLATE**
- PP-221 STEEL DRIVE PLATE / .080" THICK (NEED QTY 5 or 6)**
- PP-221-A STEEL DRIVE PLATE / .047" THICK (NEED QTY 2 or 3)**
- PP-207-A PRESSURE PLATE / ALUMINUM / 1990 & LATER**
- PP-218-M DIAPHRAGM SPRING / SILVER**
- PP-205-L LOCK TAB FOR RETAINER NUTS (REQUIRES QTY 2)**
- PP-217 DIAPHRAGM SPRING RETAINER / BLACK OXIDE FLAT SIDE FACES OUT/BEVELED SIDE FACES SPRING**
- PP-014-C SPRING RETAINER NUTS (SHOULDERED)/.750 LONG 5/8" WRENCH SIZE (REQUIRES QTY 4)**
- PP-017 SEAL FOR CLUTCH HUB NUT**
- PP-016-5 ADJUSTER ROD / SCREWS INTO PRESSURE PLATE / 3"**
- PP-A-016-S CLUTCH HUB NUT w/SEAL (SPLINED SHAFT)**