

BRUTE II CLASSIC™ BELT DRIVES



REPLACEMENT PARTS LIST

BRUTE II CLASSIC™

FRONT PULLEYS

- P-31-T 31 TOOTH / TAPERED SHAFT / 1937-54
- P-31-S 31 TOOTH / SPLINED SHAFT / 1955-84

REAR PULLEYS

- CP-47-K . . . 47 TOOTH / 1937-84 / KICK ONLY / DIAPHRAGM CLUTCH
- CP-47-EL . . 47 TOOTH / 1965-84 / ELECTRIC START / DIAPHRAGM CLUTCH / 4 or 5-SPD USE w/IDLER BEARING

STARTER RING GEAR KIT

- 2171-0015 . . . STARTER RING GEAR KIT / 66 TOOTH



REPLACEMENT BELTS

- 2021-0001 (OLD #1185) 11mm / 1-1/2" WIDE / 99 TOOTH / 1937-84 / ELECTRIC or KICK / USE w/IDLER BEARING
- 2024-0001 (OLD #1185-K) . . . 11mm / 1-1/2" WIDE / 99 TOOTH / KEVLAR / 1937-84 / ELECTRIC or KICK / USE w/IDLER BEARING
- 2021-0010 (OLD #30991) 11mm / 1-1/2" WIDE / 92 TOOTH / 1979-84 / 5-SPD / USE w/IDLER BEARING
- 2024-0006 (OLD#30991-K) . . . 11mm / 1-1/2" WIDE / 92 TOOTH / KEVLAR / 1979-84 / 5-SPD / USE w/IDLER BEARING

BELT IDLER

- 2017-0005 . . IDLER BEARING KIT / INCLUDES IDLER BEARING ASSY (PP-122), SERRATED PLATE (PP-120) & NUT FOR PLATE (PP-121)
- PP-122 IDLER BEARING w/SMALL PLATE --- PP-120 SERRATED PLATE FOR INNER PRIMARY --- PP-121 . . . NUT FOR PLATE

BELT GUIDE / ENGINE NUT & WASHER

- PP-115 OUTSIDE GUIDE FOR FRONT PULLEY
- PP-116-T NUT / FRONT PULLEY / TAPERED
- PP-116-S NUT / FRONT PULLEY / SPLINED
- PP-117-T WASHER FOR TAPERED SHAFT FRONT PULLEY
- PP-117-S WASHER FOR SPLINED SHAFT FRONT PULLEY

FRONT PULLEY INSERTS

- PP-IS-T STANDARD INSERT (NO OFFSET) / TAPERED SHAFT
- PP-IS-1 STANDARD INSERT (NO OFFSET) / SPLINED SHAFT
- PP-IS-S INSERT SCREW / 1-4-28 x 3/4" (REQUIRES QTY 5)
- PP-IS-RP ROLLPIN (STEEL) / 1/4" x 5/8" (REQUIRES QTY 2)

EXPLODED VIEW OF CLUTCH ASSEMBLY

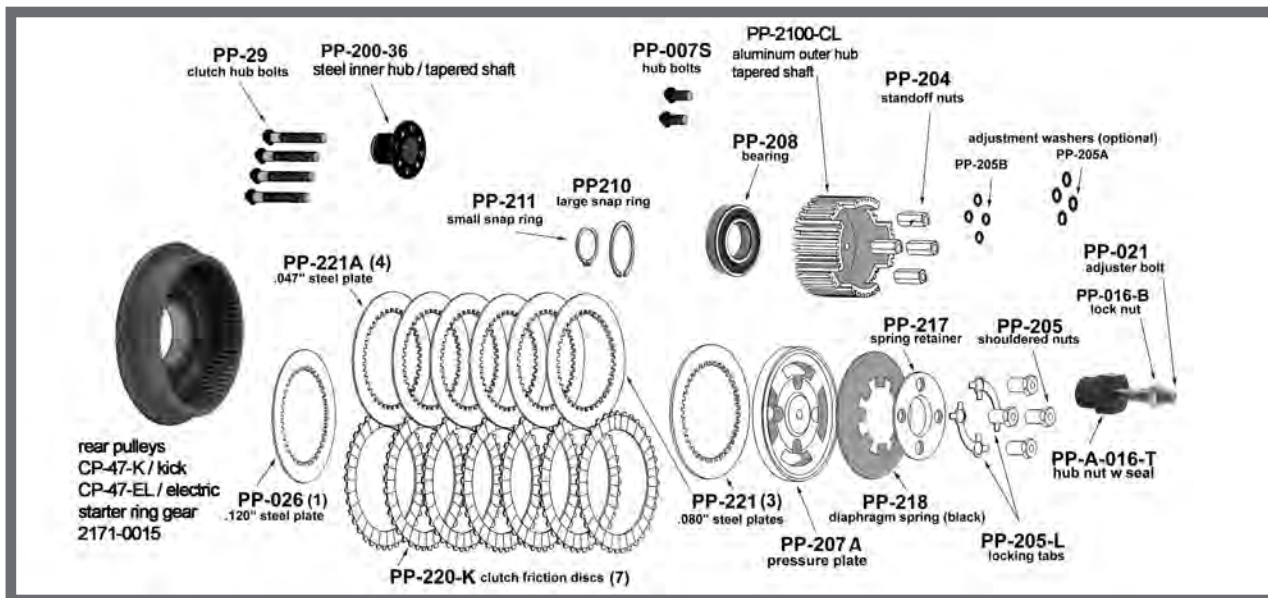

PP-007-36-CL . . . CLUTCH HUB ASSEMBLY / FITS CLASSIC DRIVES
TAPERED SHAFT / BIG TWINS 1936-1984

PP-204 STAND-OFF NUTS (REQUIRES QTY4)

PP-29 BUTTONHEAD SCREW- 5/16-18 x 1-3/4" (REQUIRES QTY 4)

PP-200-36 STEEL INNER HUB / CLASSIC DRIVES / TAPERED SHAFT

PP-007-S CLUTCH HUB BOLTS - 1/4-28 x 3/8" SHCS (REQUIRES QTY 2)

PP-2100-CL . . . CLUTCH HUB / ALUMINUM OUTER HUB / TAPERED SHAFT

PP-208 BEARING FOR CLUTCH BASKET

PP-210 SNAP RING FOR CLUTCH BASKET BEARING

PBC-2-CL REPLACEMENT CLUTCH PACK / PACK HEIGHT = 1.635"- 1.660"

PP-220 -K FRICTION PLATE / KEVLAR / .150" THICK (REQUIRES QTY 7)

PP-221-A CLUTCH STEEL PLATE / .047" THICK (REQUIRES QTY 3 or 4)

PP-221 CLUTCH STEEL PLATE / .080" THICK (REQUIRES QTY 3 or 4)

PP-026 STEEL DRIVE PLATE / .120" THICK / FOR REAR NEW STYLE HUB

PP-218 DIAPHRAGM SPRING / BLACK / STOCK TO MILD APP'S

PP-217 DIAPHRAGM SPRING RETAINER

PP-205-L LOCK TAB FOR SPRING RETAINER (REQUIRES QTY 2)

PP-205 NUTS FOR SPRING RETAINER (SHOULDERED) / REQUIRES QTY 4

PP-021 CLUTCH ADJUSTING SCREW

PP-016-B JAMNUT / CLUTCH ADJUSTING SCREW

PP-A-016-T . . . CLUTCH HUB NUT w/SEAL (TAPERED SHAFT)

PP-016-T CLUTCH HUB NUT ONLY (TAPERED SHAFT)

PP-017 CLUTCH HUB NUT SEAL